

POINT OF BEGINNING
NW COR S 1/2 OF SE 1/4
SEC 24, T14N, R12E
SARPY COUNTY, NE

S89°53'23"E
462.60'

UNPLATTED

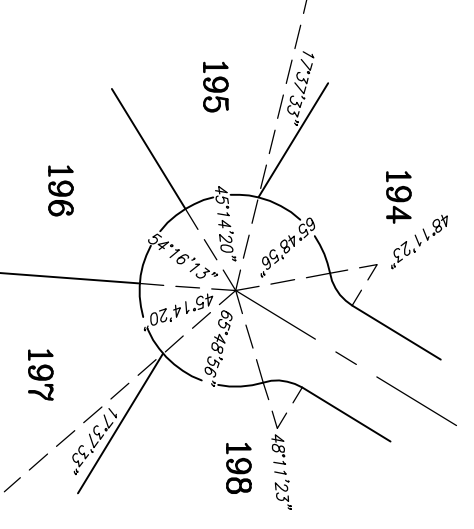

REMINGTON
CIRCLE

NOTES

1. ALL DISTANCES ARE SHOWN IN DECIMAL FEET.
2. ALL DISTANCES SHOWN ALONG CURVES ARE ARC DISTANCES NOT CHORD DISTANCES.
3. ALL ANGLES ARE 90° UNLESS OTHERWISE NOTED.
4. ALL LOT LINES ON CURVED STREETS ARE RADIAL UNLESS OTHERWISE NOTED (N.R.).
5. DISTANCES AND ANGLES SHOWN IN PARENTHESES REFER TO EASEMENTS.
6. ALL CUL-DE-SAC RADII ARE 50 FEET UNLESS NOTED OTHERWISE.
7. ALL CUL-DE-SAC THROAT RADII ARE 25 FEET UNLESS NOTED OTHERWISE.
8. LOTS 134 THROUGH 148, INCLUSIVE, WILL HAVE NO DIRECT VEHICULAR ACCESS TO CORNHUSKER ROAD.
9. LOTS 123 THROUGH 134, INCLUSIVE, WILL HAVE NO DIRECT VEHICULAR ACCESS TO 66TH STREET.

CENTERLINE CURVE DATA

CURVE	RADIUS	ARC LENGTH	CHORD LEN	DELTA ANGLE
C1	500.00'	19.91'	19.91'	02°16'55"
C2	500.00'	18.36'	18.35'	02°06'12"
C3	166.43'	91.63'	90.48'	31°32'39"
C4	100.00'	102.34'	97.93'	58°38'04"
C5	350.00'	192.89'	190.27'	31°32'39"

SW COR. S 1/2 OF SE 1/4
SEC 24, T14N, R12E
SARPY COUNTY, NE

CORNHUSKER ROAD
(OLD HWY 208)

